

FONTO 2000



Floor outlets with hinged cover and leveling frame
(Leveling feet optionally available)

Application

Indoor use

Technical data

Outer dimensions (L x W)	110 x 95 mm
Installation depth	approx. 75 mm (delivery setting)
Levellable	72 - 78 mm
Installation height with leveling feet	88 - 130 mm
Installation height with threaded pin extension	88* - 230 mm
Material	aluminium untreated
Color	aluminium untreated
Maximum static load according to EN 50085	20kN
Maximum conductor cross-section	depending on module use

Features

- In staggered condition adjustable frame (+/- 3 mm) for easy adaptation to the finished floor level
- Floor socket to be set floor leveled with hinged cover
- For 1x input 45 x 45 x 4 mm (e.g. Schuko, RJ45, TV, HDMI, USB etc.)
- Can be travelled over when closed
- Suitable for maintenance with wet sweeping devices when closed (IP65)
- When plugged in: only for dry-cleaned floors (IP20)

EDP No.	Product-ID-No. / Description
840886	FONTO.2000-1AG / Floor outlets with hinged cover, 110x95x75 mm, closed IP65, alu-natural ground , 1 modul 45x45 mm, levellable +/- 3 mm
840900	FONTO.2000-1PG.RAL9006.WEISSALU / Floor outlets with hinged cover, 110x95x75 mm, closed IP65, coated in RAL 9006 white aluminum , 1 modul 45x45 mm, levellable +/- 3 mm

Accessories	Installation height
107159 FONTO.MASSO.NIVELLIERSCHRAUBE. SENKVERTEILER / Leveling screw: consisting of: 1x base plate + 1x leveling pin M8x60	88 - 130 mm
Option	
840768 M8.160.A2.DIN976-1 / Threaded rod M8 x 160 mm suitable for base plate 107159	88* - 230 mm

Inserts modul FONTO on page 14 - 15 !

* Shorten the setscrew as required

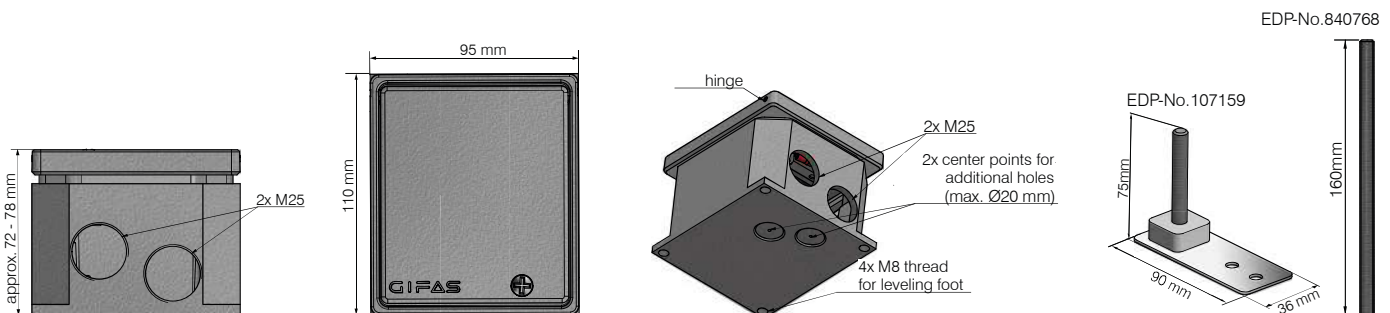

Leveling feet are only used to set up the floor socket. Loading class / stability is only achieved by backfilling the floor socket with solid material (mortar, concrete ...).

CE

07/2021/1.0